



Instruction Manual

Fun Pop 8 Oz. Popper

Model No. 2408, 2408EX









GOLD MEDAL[®] PRODUCTS CO.

10700 Medallion Drive, Cincinnati, Ohio 45241-4807 USA



SAFETY PRECAUTIONS

	<p style="text-align: center;">⚠ DANGER</p> <p>Machine must be properly grounded to prevent electrical shock to personnel. Failure to do so could result in serious injury, or death. Do NOT immerse any part of this equipment in water. Do NOT use excessive water when cleaning. Keep cord and plug off the ground and away from moisture. Always unplug the equipment before cleaning or servicing.</p> <p style="text-align: right;">008GEND1012</p>
	<p style="text-align: center;">⚠ WARNING</p> <p>To avoid burns, do NOT touch heated surfaces. Do NOT place or leave objects in contact with heated surfaces. <i>(Gold Medal Products does not assume any liability for injury due to careless handling and/or reckless operation of this equipment.)</i></p> <p style="text-align: right;">009GHW1012</p>
	<p style="text-align: center;">⚠ WARNING</p> <p>ALWAYS wear safety glasses when servicing this equipment.</p> <p style="text-align: right;">010GENW1012</p>
	<p style="text-align: center;">⚠ WARNING</p> <p>Any alterations to this equipment will void the warranty and may cause a dangerous situation. NEVER make alterations to the equipment. Make sure all machine switches are in the OFF position before plugging the equipment into the receptacle.</p> <p style="text-align: right;">011GENW1012</p>
	<p style="text-align: center;">⚠ CAUTION</p> <p>Do NOT allow direct contact of this equipment by the public when used in food service locations. Only personnel trained and experienced in the equipment operation may operate this equipment. Carefully read all instructions before operation.</p> <p style="text-align: right;">012GENC1012</p>
	<p style="text-align: center;">⚠ CAUTION</p> <p>This machine is NOT to be operated by minors. Minors are classified as anyone under the age of 18.</p> <p style="text-align: right;">007GENC1012</p>

NOTE: Improvements are always being made to Gold Medal Products' equipment. This information may not be the latest available for your purposes. It is critical that you call Gold Medal Products technical Service Department at 1-800-543-0862 for any questions about your machine operations, replacement parts, or any service questions.



INSTALLATION INSTRUCTIONS

Inspection of Shipment

Unpack all cartons and check thoroughly for any damage that may have occurred during transit. Damage claims should be filed immediately with the transportation company.

Setup

Your new Popper is completely assembled and tested at the factory. Remove all packing material and tape before starting operation.

Electrical Requirements

The following power supply must be provided:

2408: 120Volts, 60 Cycle, 1053W

2408EX: 230V, 50 Cycle, 1053W

	⚠ DANGER
	<p>Machine must be properly grounded to prevent electrical shock to personnel. Failure to do so could result in serious injury, or death.</p> <p>Do NOT immerse any part of this equipment in water.</p> <p>Do NOT use excessive water when cleaning.</p> <p>Keep cord and plug off the ground and away from moisture.</p> <p>Always unplug the equipment before cleaning or servicing.</p>

Your electrician must furnish sufficient power for proper machine operation. We recommend this steamer be on a dedicated and protected circuit. Failure to wire properly will void the warranty and may result in damage to the machine. It is Gold Medal Products Company's recommendation that this machine be plugged directly into a wall outlet. The use of extension cords is not recommended due to safety concerns, and may cause sacrificed and/or reduced performance.

Before You Plug In Machine

1. Make sure the wall outlet can accept the grounded plugs (where applicable) on the power supply cord.
2. The wall outlet must have the proper polarity. If in doubt, have a competent electrician inspect the outlet and correct if necessary.
3. **DO NOT** use a grounded to un-grounded receptacle adapter.



OPERATING INSTRUCTIONS

Controls and Their Functions

LIGHT/WARMER SWITCH

This switch heats the bottom of the corn pan and turns on the light.

KETTLE MOTOR SWITCH

This switch turns on the motor which drives the kettle agitator shaft.

KETTLE HEAT SWITCH

This switch turns on the heat element.

Amount of Popcorn and Oil

Your new popper is equipped with a corn measure cup. Popcorn popped in coconut oil stays fresher longer. Coconut oil does not leave black deposits in your kettle like other oils.

Corn charge: 8 oz.

Oil charge: 2.6 oz.

Flavacol: 1 tablespoon

8 Oz. Accessory Pack

Part No. 2071: Scoop

Part No. 47174: Measure Cup

Part No. 47150: Oil Measure Cup

Part No. 47678: Flavacol Measure



CARE AND CLEANING

1. Each time you finish a series of popping, wipe the outside of the kettle with a soft cloth to remove any oil drippings on the outside of the kettle.
2. After you finish popping for the day, allow kettle to cool until it is not too hot to handle, but still warm.
3. Unplug kettle and remove it from the machine.
4. With a cloth, wipe out the inside of the kettle, kettle lid, crossbar, outside and underneath of the kettle.
DO NOT place the kettle in water. This will cause damage to the electrical components and will void your warranty.
5. Cleaning the cabinet of your machine is easy. Take a clean cloth and wipe excess grease from the glass. Wipe the outside of the machine also.

NOTE: Never use a glass or plastic cleaner that contains ammonia. It will crack the plastic on the machine.

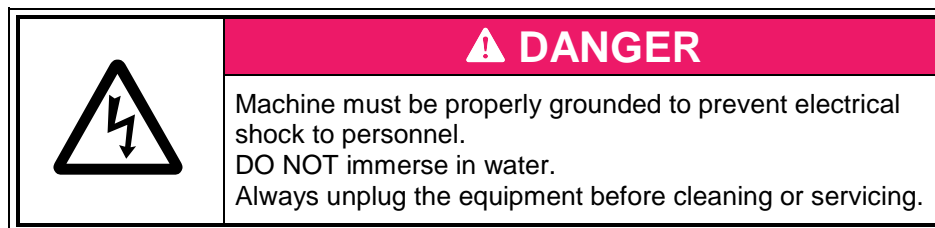

Good sanitation practice demands that all food cooking equipment be cleaned regularly. A clean looking, well-kept machine is one of the best ways of advertising your product.



MAINTENANCE INSTRUCTIONS

	⚠ DANGER
	Do NOT immerse the equipment in water. Unplug your machine before servicing.

	⚠ WARNING
	Adequate eye protection must be used when servicing this equipment to prevent eye injury.

	⚠ CAUTION
	THE FOLLOWING SECTIONS OF THIS MANUAL ARE INTENDED ONLY FOR QUALIFIED SERVICE PERSONNEL WHO ARE FAMILIAR WITH ELECTRICAL EQUIPMENT. THESE ARE NOT INTENDED FOR THE OPERATOR.



ORDERING SPARE PARTS

1. Identify the needed part by checking it against the photos, illustrations, and/or parts list.
2. When ordering, please include part number, part name, and quantity needed.
3. Please include your model number, serial number, and date of manufacture (located on the machine nameplate) with your order.
4. Address all parts orders to:

Parts Department
Gold Medal Products Co.
10700 Medallion Drive
Cincinnati, Ohio 45241-4807

Or, place orders by phone or online:

Phone: (800) 543-0862

(513) 769-7676

Fax: (800) 542-1496

(513) 769-8500

E-mail: info@gmpopcorn.com

Web Page: www.gmpopcorn.com



Cabinet Exterior

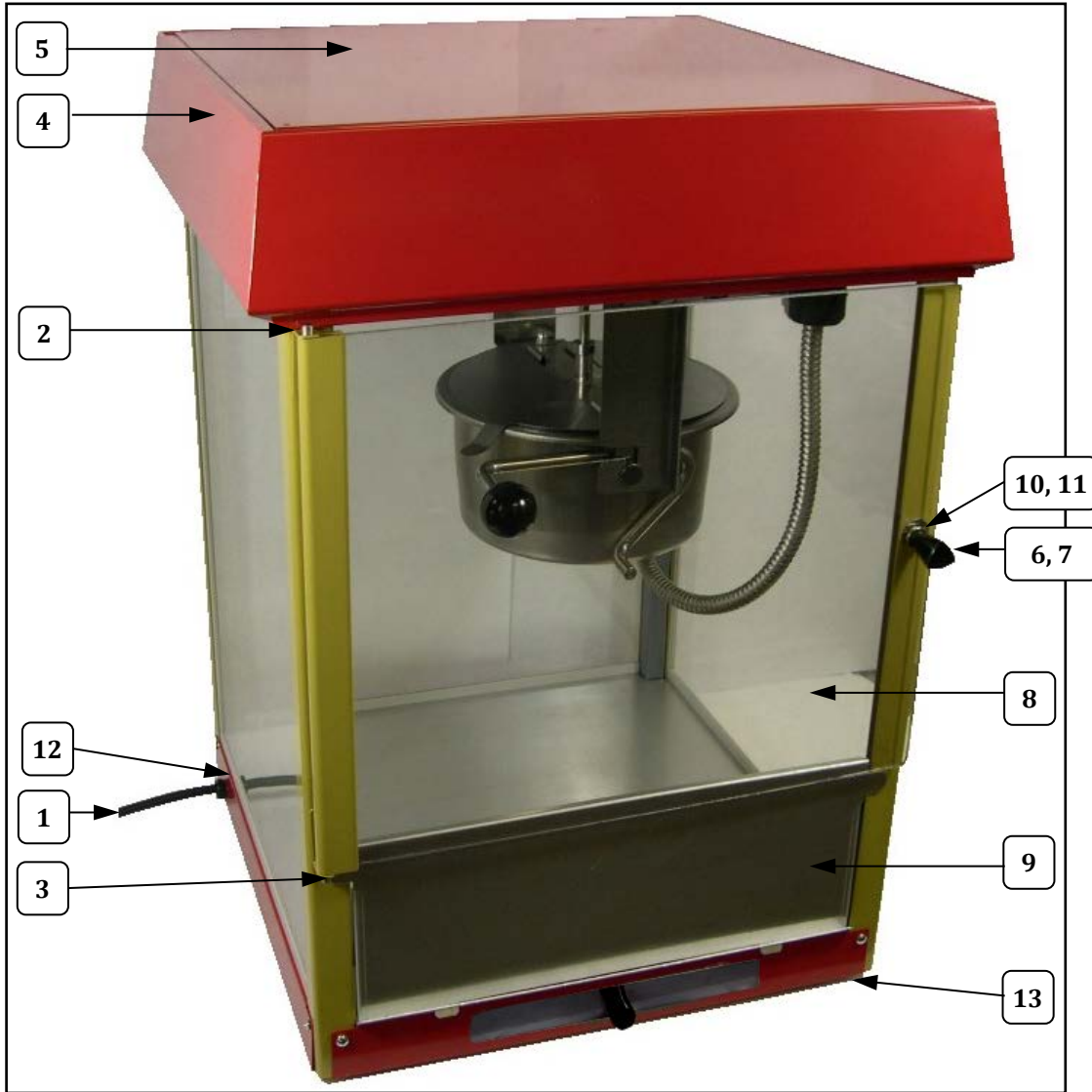

Item	Part No.	Model(s)	Part Description	Qty.
1	22038	ALL	LEAD-IN CORD ASSEMBLY	1
2	55060	ALL	TOP HINGE BRACKET	1
3	55061	ALL	BOTTOM HINGE BRACKET	1
4	58104	ALL	TOP DOME ASSEMBLY	1
5	58101	ALL	DOME COVER	1
6	47120	ALL	KNOB LID LEFT	2
7	55104	ALL	LATCH CATCH	1
8	58065	ALL	DOOR ASSEMBLY (includes item no. 2)	1
9	58113	ALL	DROP PANEL	1
10	50013	ALL	MAGNET	1
11	20066	ALL	SCREW (for knob)	1
12	76026	ALL	STRAIN RELIEF	1
13	87247	ALL	RUBBER BUMPER FOOT (not shown)	4



Cabinet Interior

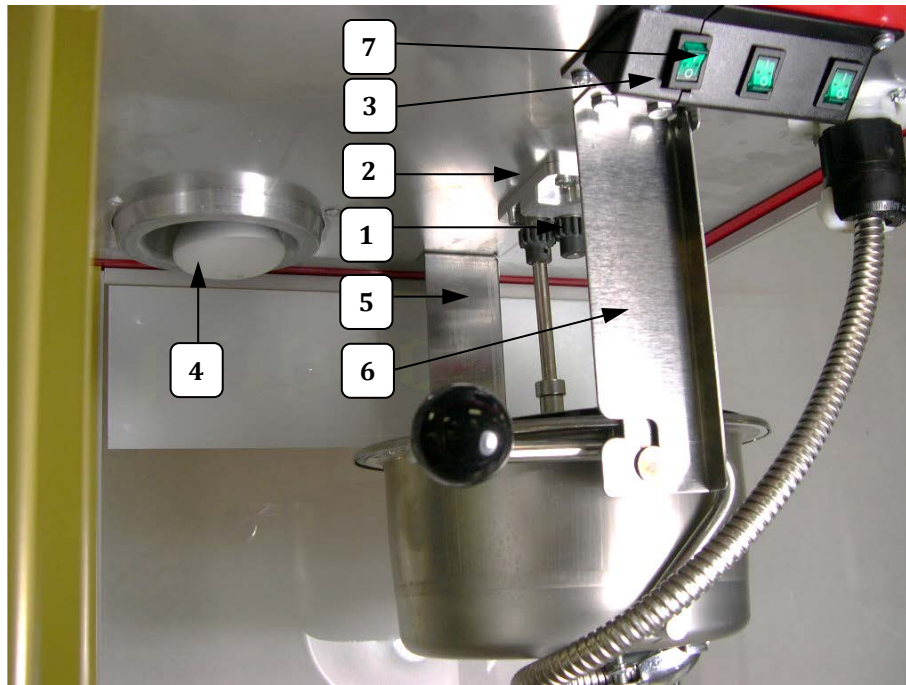

Item	Part No.	Model(s)	Part Description	Qty.
1	47060	ALL	SPUR GEAR	1
2	67194A	ALL	GEAR BLOCK ASSEMBLY	1
3	55076	ALL	SWITCH MOUNT BOX	1
4	42947	2408	50W COATED BULD	1
	13122	2408EX	40W 240V COATED FLOOD	
5	49010	ALL	FRONT HANGER ARM	1
6	49009	ALL	REAR HANGER ARM	1
7	42532	ALL	DPST ROCKER SWITCH	3



Cabinet Bottom

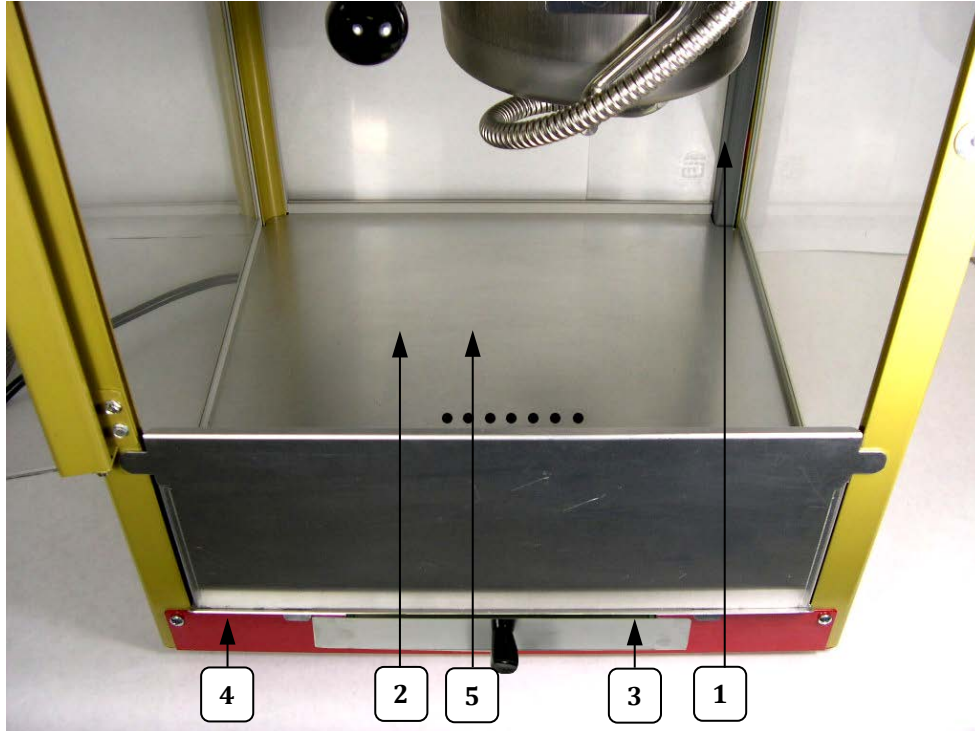

Item	Part No.	Model(s)	Part Description	Qty.
1	58077	ALL	WIRE ROUTE COVER	1
2	58110	ALL	CORN PAN	1
3	49100	ALL	OLD MAID PAN	1
4	58064	2408	BASE PAN	1
	58064EX	2408EX	EXPORT BASE PAN	
5	40557	2408	120V 20W FOIL HEATER (bottom of corn pan)	1
	40557EX	2408EX	230V 20W FOIL HEATER (bottm of corn pan)	
6	55104	ALL	LATCH CATCH	1

Motor Plate

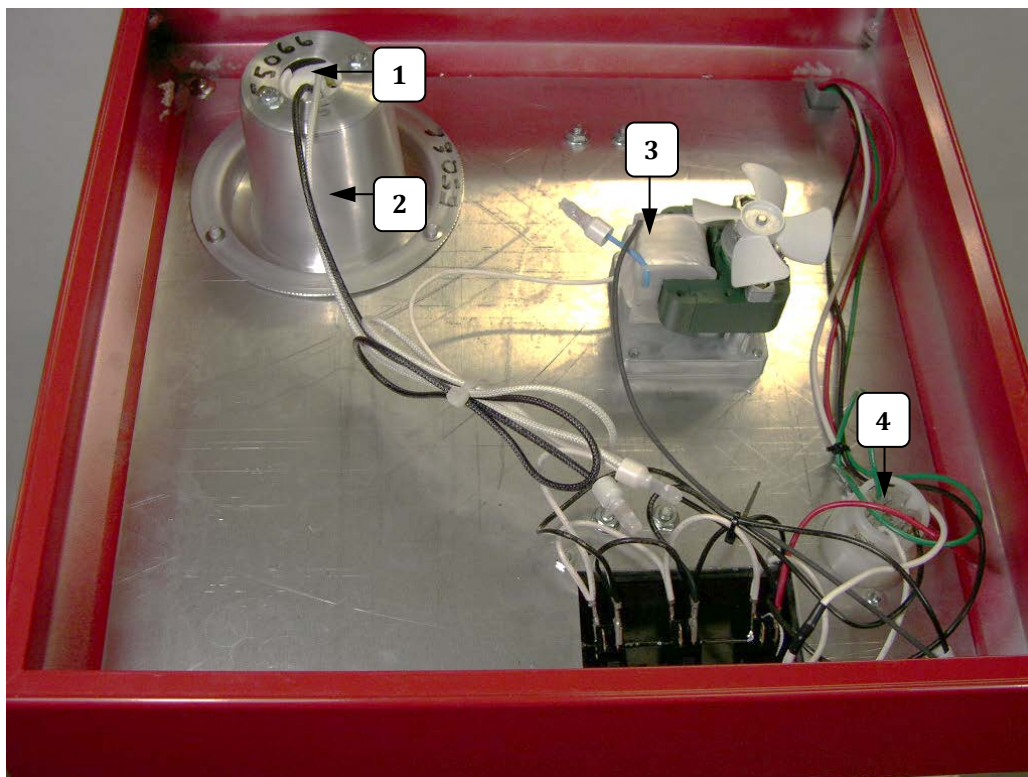

Item	Part No.	Model(s)	Part Description	Qty.
1	56050	ALL	LIGHT BULB SOCKET	1
2	55066	ALL	LIGHT CONE	1
3	47038	2408	120V KETTLE DRIVE MOTOR	1
	47067	2408EX	230V KETTLE DRIVE MOTOR	
4	49330	ALL	15A KETTLE RECEPTACLE	1



Kettle Assembly

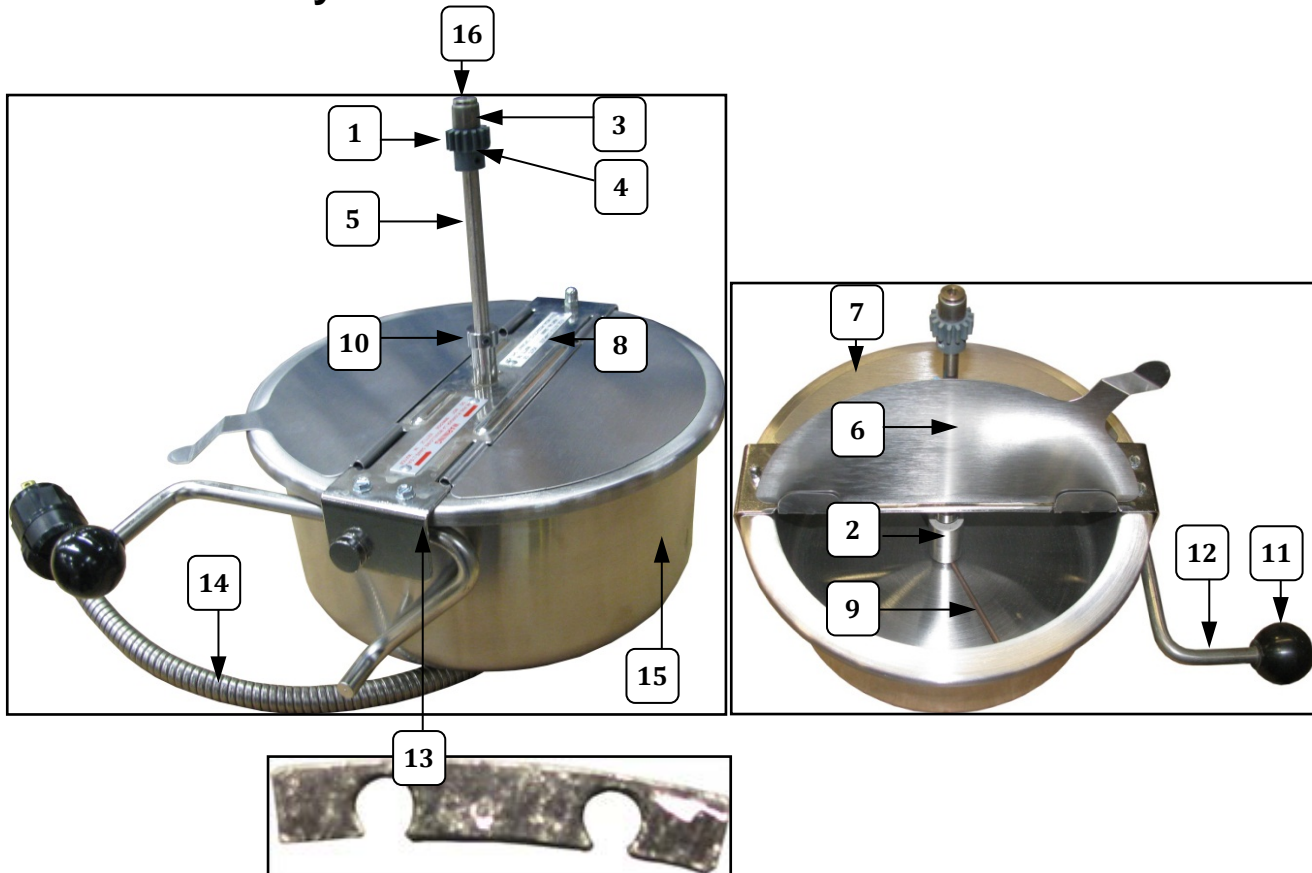

Item	Part No.	Model(s)	Part Description	Qty.
1	47060	ALL	SPUR GEAR	1
2	49013	ALL	AGITATOR WEIGHT	1
3	47106	ALL	NEEDLE BEARING	1
4	41742	ALL	SET SCREW	3
5	49437	ALL	AGITATOR SHAFT	1
6	49017	ALL	FRONT LID WITH FORMED LIFTER	1
7	49016	ALL	REAR KETTLE LID	1
8	59907	58000	CROSSBAR ASSEMBLY	1
	59907EX	58000EX	CROSSBAR ASSEMBLY	
9	49011	58000	STIR ROD	1
10	46649	ALL	SET COLLAR	3
11	47110	ALL	KNOB DUMP HANDLE	1
12	49314	ALL	RH DUMP HANDLE	1
13	49362	ALL	SPACER DUMP HANDLE	1
14	49328	58000	KETTLE LEAD ASSEMBLY	1
	49490	58000EX	EXPORT KETTLE LEAD ASSEMBLY	
15	49431	ALL	KETTLE SHELL	1
16	49701	ALL	RETAINING RING	1



Kettle Assembly

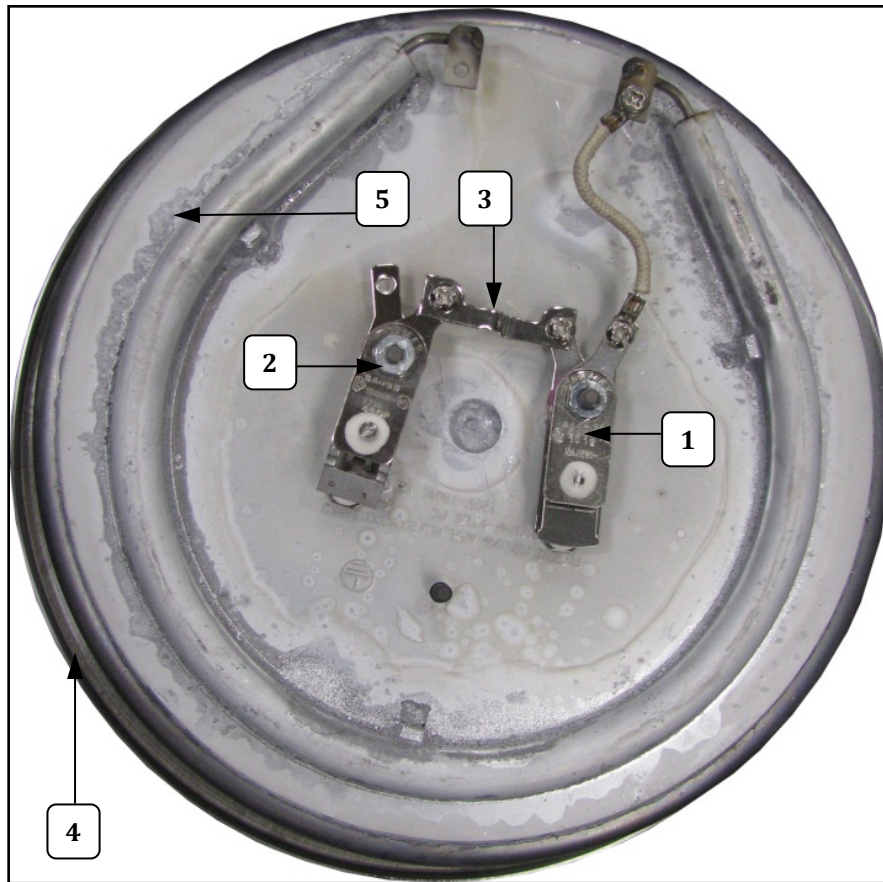

Item	Part No.	Model(s)	Part Description	Qty.
1	76702	58000	THERMOSTAT 525°F	1
2	76089	58000	THERMOSTAT 450°F	1
	76089	58000EX	THERMOSTAT 450°F	2
3	47193	ALL	THERMOSTAT SHUNT BAR	1
4	49368	ALL	KETTLE GASKET	1
5	58008	58000	120V KETTLE/HEATER	1
	58008EX	58000EX	925W KETTLE/HEATER	



WIRING DIAGRAM

Model No. 2408

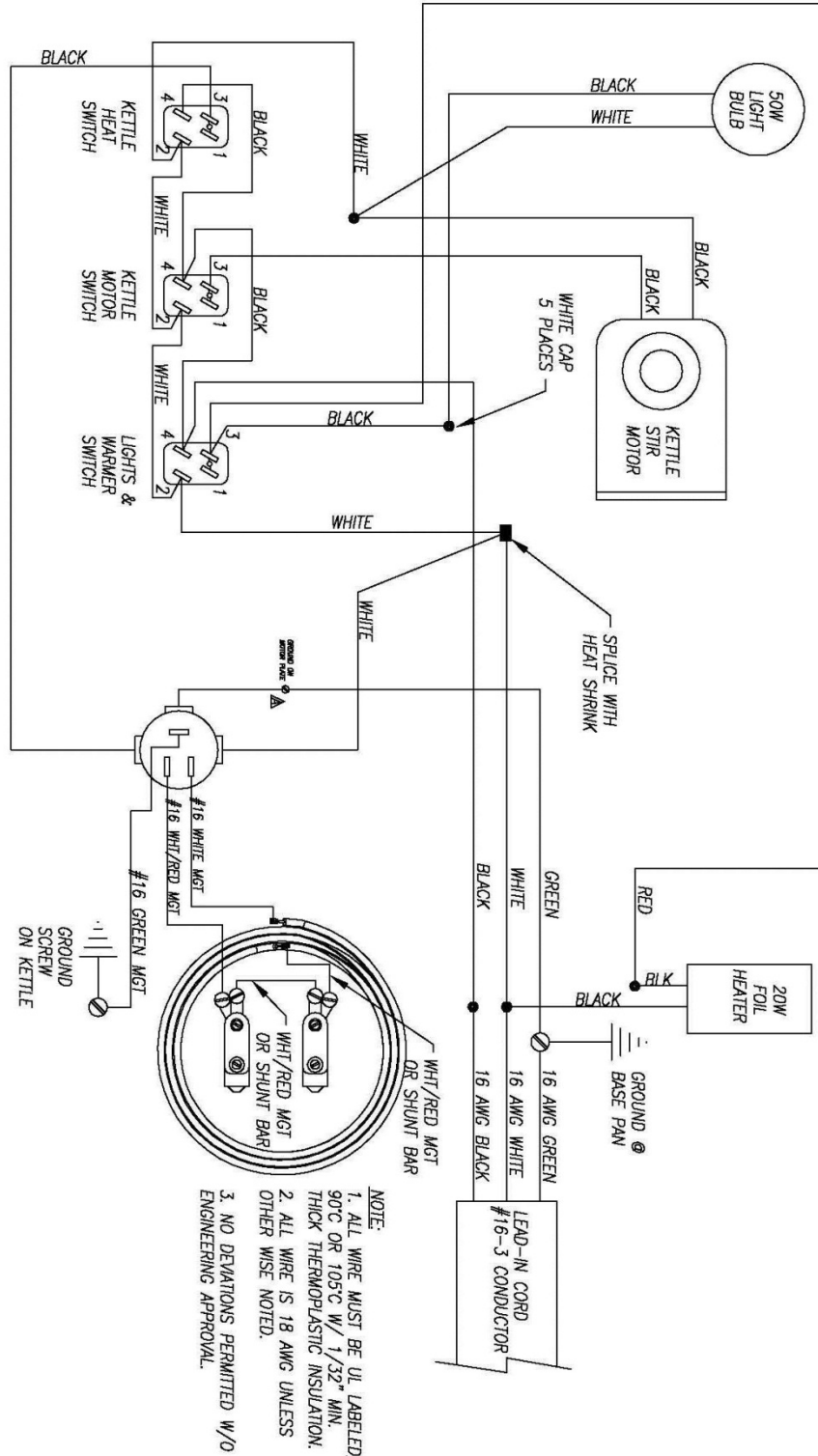



WIRING DIAGRAM

Model No. 2408EX

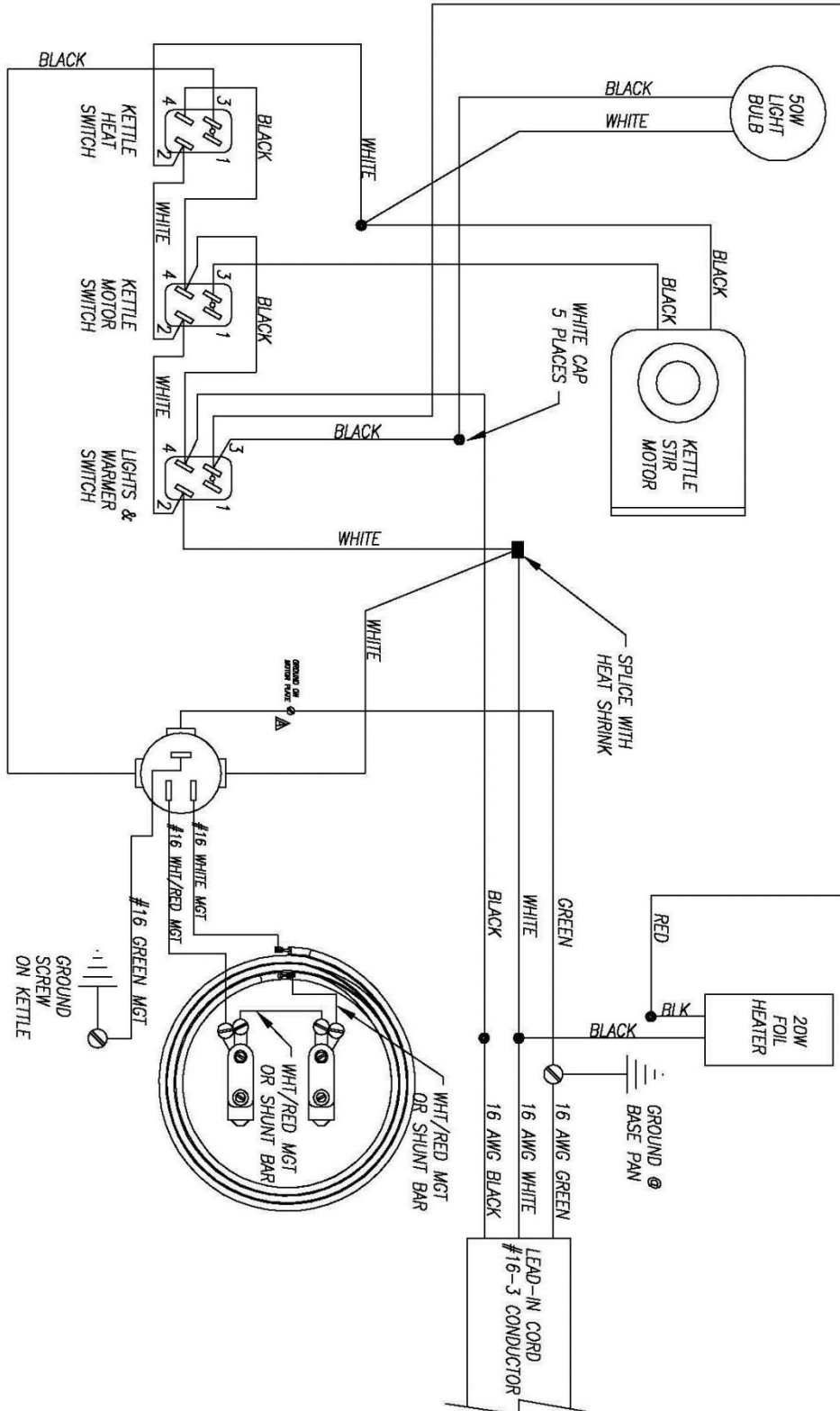



WARRANTY

WE WARRANT to the original purchaser the Gold Medal equipment sold by us to be free from defects in material or workmanship under normal use and service. Our obligation under this warranty shall be limited to the repair or replacement of any defective part for a period of six (6) months from the date of sale to the Original Purchaser with regard to labor and two (2) years with regard to parts and does not cover damage to the equipment caused by accident, alteration, improper use, voltage, abuse, or failure to follow instructions.

THIS WARRANTY IS IN LIEU OF ALL OTHER WARRANTIES EXPRESSED OR IMPLIED, AND OF ALL OTHER OBLIGATIONS OR LIABILITIES ON OUR PART, INCLUDING THE IMPLIED WARRANTY OF MERCHANTABILITY. THERE ARE NO WARRANTIES WHICH EXTEND BEYOND THE DESCRIPTION ON THE FACE HEREOF. We neither assume, nor authorize any other person to assume for us, any other obligation or liability in connection with the sale of said GOLD MEDAL equipment or any part thereof.

The term "Original Purchaser" as used in this warranty shall be deemed to mean that person, firm, association, or corporation who was billed by the GOLD MEDAL PRODUCTS COMPANY, or their authorized distributor for the equipment.

THIS WARRANTY HAS NO EFFECT AND IS VOID UNLESS THE ORIGINAL PURCHASER FIRST CALLS GOLD MEDAL PRODUCTS COMPANY AT 1-800-543-0862 TO DISCUSS WITH OUR SERVICE REPRESENTATIVE THE EQUIPMENT PROBLEM, AND, IF NECESSARY, FOR INSTRUCTIONS CONCERNING THE REPAIR OR REPLACEMENT OF PARTS.

NOTE: This equipment is manufactured and sold for commercial use only.



GOLD MEDAL[®] PRODUCTS CO.

10700 Medallion Drive, Cincinnati, Ohio 45241-4807 USA

www.gmpopcorn.com

Phone: (800) 543-0862

(513) 769-7676

Fax: (800) 542-1496

(513) 769-8500