

# *Pro Pop 12/14 oz. Unimaxx*

## Model 2214ST

### Instruction Manual

**(2214ST shown, see next page for other models covered)**



Customer Side

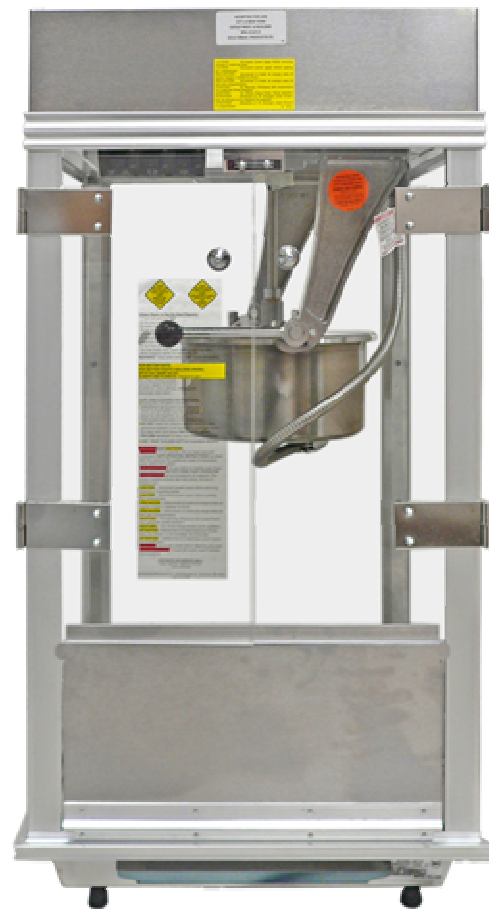

Operator Side

 **GOLD MEDAL**®  
**FUNFOOD EQUIPMENT AND SUPPLIES**

Cincinnati, OH 45241-4807 USA



**Model 2212  
Mega Pop  
12/14 oz. Unimaxx**



**Model 2214  
Red Top 12  
12/14 oz. Unimaxx**



**Model 2213  
Gay 90s Mega Pop  
12/14 oz. Unimaxx**

**With the exception of the lighted dome on the Model 2214ST, all service parts are common between models 2212, 2213, 2214, and 2214ST**

# Table of Contents

<b>Safety Precautions</b> .....	4
<b>Installation Instructions</b> .....	5
<b>Operating Instructions</b> .....	6-7
<b>Cleaning Instructions</b> .....	8
<b>Maintenance Instructions</b> .....	9
Troubleshooting .....	10
Ordering Spare Parts .....	11
<b>System Parts Location Section</b> .....	12-19
Cabinet Breakdown & Door Hardware .....	12-13
Cabinet Interior–Ceiling .....	13-14
Bottom Corn Pan Assembly .....	14-15
Dome Assembly (2024ST only) .....	15
Kettle Shell Components .....	16
Lid and Agitator Assembly .....	17
Unimaxx 12/14 oz Kettle Specification .....	18
Motor Plate Assembly .....	19
<b>Electrical Schematic</b> .....	20
<b>Warranty</b> .....	21

# SAFETY PRECAUTIONS



## **⚠ DANGER**

Machine **MUST** be properly grounded to prevent electrical shock to personnel. Failure to do so could result in serious injury, or death. Do **NOT** immerse the kettle, warmer, or any other part of this equipment in water. Always unplug the equipment before cleaning or servicing. Do not use excessive water when cleaning.



## **⚠ WARNING**

To avoid serious burns, do **NOT** touch the kettle while it is hot.



## **⚠ WARNING**

**ALWAYS** wear safety glasses when servicing this equipment.



## **⚠ WARNING**

Any alterations to this equipment will void the warranty and may cause a dangerous situation. **NEVER** make alterations to the equipment. Make sure all machine switches are in the off position before plugging the equipment into the receptacle.



## **⚠ CAUTION**

Do **NOT** allow direct contact with this equipment and the general public when used in food service locations. Only personnel that are trained and familiar with the equipment should operate the equipment. Carefully read all installation instructions before operation.



## **⚠ CAUTION**

This machine is **NOT** to be operated by minors. Minors are classified as anyone under the age of 18.

## NOTE

The information, specifications and illustrations contained in this manual represent the latest data available at time of publication. Right is reserved to make changes as required at the discretion of Gold Medal Products Company without notice.

# INSTALLATION INSTRUCTIONS

**Note:** Make sure to have all employees read the instruction manual thoroughly before operating this machine.

## Checking Shipment

Unpack all cartons and check thoroughly for any damage that may have occurred during transit. Damage claims should be filed immediately with the transportation company. Gold Medal is not responsible for damage that occurs in transit.

## Electrical Requirements

### Domestic models only: 120v, 15A, 60 Hz.

This popper must be operated on a dedicated and circuit-protected 15 Amp line. Your electrician must furnish sufficient current for proper operation of your machine.

	<b>⚠ DANGER</b>
<p>Machine must be properly grounded to prevent shock in case of electrical problems.          Wall receptacle must be wired as shown on the receptacle.          Failure to wire properly will void the warranty and can result in damage to motors, elements, relay, lights, etc.</p>	

## FINAL PREPARATIONS

The popcorn machine was adjusted, inspected, and tested before it left the factory. After removing machine from shipping box, remove all tape and packing material in or on the machine before beginning operation.

<b>⚠ WARNING</b>

<p>To avoid serious burns, do <b>NOT</b> touch the kettle while it is hot!</p>

# OPERATING INSTRUCTIONS

## CONTROLS AND THEIR FUNCTIONS

### **LIGHT/WARMER SWITCH**

Turns on all of the lights, interior, and dome on your popcorn machine, and operates the element for the heated corn pan.

### **KETTLE HEAT SWITCH**

Operates the heating elements in the popping kettle.

### **KETTLE MOTOR SWITCH**

Operates the kettle agitator motor.



Light/Warmer Switch

Kettle Motor Switch

Kettle Heat Switch

# POPPING CORN

## AMOUNT OF POPCORN AND OIL

Your new popper is equipped with a corn, salt, and oil measure. We recommend flavored and colored coconut oil. Popcorn popped in coconut oil stays fresh longer and does not leave black deposits in your kettle like other oils. Use only top quality fresh hybrid popcorn from reputable suppliers.

Corn charge – 12 oz./14 oz.

Oil charge – 3.5 oz./4.2 oz.

Flavacol – 14.7 cc (measure included with accessory kit)

\*for best results use mega-pop premeasured pouches (item # 2839)

## POPPING INSTRUCTIONS

1. Turn KETTLE HEAT and KETTLE MOTOR switch ON.
2. Make test pop with 3 kernels of corn and 1 oz. (30 ml) of oil.
3. Load pre-measured popcorn and oil pouch into kettle, or add ingredients in amounts specified above.
4. When corn has popped, dump kettle.
5. Repeat cycle starting with Item #3; always pop 3-5 batches for best popcorn.

When you are finished popping, make sure “KETTLE HEAT” and “KETTLE MOTOR” switches are turned “OFF”.

**NEVER LEAVE THE KETTLE HEAT ON WHEN YOU ARE NOT POPPING CORN.**



# CLEANING INSTRUCTIONS

## DAILY:

### CLEAN THE KETTLE

1. As you pop corn, wipe the kettle with a clean cloth. It is easy to keep the outside clean when the kettle is warm and the oil is not baked on. CAUTION: The hot kettle will cause burns if you touch it with your hand. Allow the kettle to cool for at least 1 hour before attempting to clean.
2. Every night, add 10 – 12 oz. of Heat'n Kleen solution (mix 2 tablespoons Heat'n Kleen per gallon of water). Turn on the kettle heat. When the water starts to boil, turn off the heat and let it work overnight.
3. The next morning, dump the solution into a bucket and wipe the inside of the kettle with a cloth.

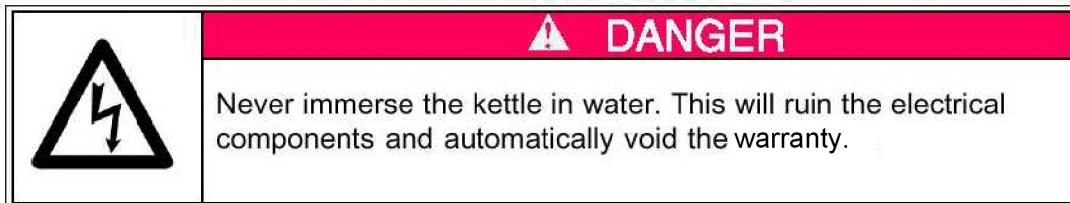

### CLEAN THE POPCORN MACHINE

1. Wipe the stainless steel parts with a clean cloth and cleaner designed for stainless steel. ***Do not use oven cleaners, as they will damage parts of the machine.***
2. Ammonia cleaners will damage the plastic doors. ***Use only non-ammonia cleaners, such as Gold Medal's – Watchdog Glass Cleaner – item number 2588.***



# MAINTENANCE INSTRUCTIONS

	<b>⚠ DANGER</b>
	Improper installation, adjustment, alteration, service or maintenance can cause property damage, injury, or death. Read the Installation, Operating, and Maintenance Instructions thoroughly. Installation should be performed by a certified electrician.

	<b>⚠ WARNING</b>
	Adequate eye protection must be used when servicing this equipment to prevent the possibility of injury.

	<b>⚠ CAUTION</b>
	THE FOLLOWING SECTIONS OF THIS MANUAL ARE INTENDED ONLY FOR QUALIFIED SERVICE PERSONNEL WHO ARE FAMILIAR WITH ELECTRICAL EQUIPMENT. THESE ARE NOT INTENDED FOR THE OPERATOR.

# TROUBLESHOOTING

Below are some common issues you may encounter, along with basic trouble shooting steps to resolve them.

## **EXPERIENCING LONG POPPING CYCLES**

If your pop cycle is longer than 4 minutes, it can be the result of several things:

- A. **LOW VOLTAGE** - If the machine is operated on low voltage, this could cause the kettle not to reach the proper operating temperature. Voltage must be at least 110v.
- B. **INADEQUATE SUPPLY LINES** - Inadequately sized electrical supply lines, in addition to being a fire hazard, would also prevent the kettle from reaching the proper operating temperature. Check with a qualified electrician.
- C. **INFERIOR CORN** - Inferior quality corn would result in longer popping cycles. Use only top quality fresh hybrid popcorn from reputable suppliers. Even then, if you let your corn pick up moisture or dry out, your popping cycles will be slower.

## **THE KETTLE DOES NOT HEAT**

Before you go any further, make sure the kettle lead-in cord is plugged in-

- A. **KETTLE HEAT SWITCH** - Check the voltage to and from the "KETTLE HEAT" switch, and if the switch is defective, replace it. (Repair should only be performed by qualified service personnel.)

## **THE MOTOR WILL NOT TURN AGITATOR**

**WARNING!** If the kettle agitator shaft is not rotating, **DO NOT** pop corn. Adjust the clearance between the kettle bottom and the stir blade to 1/32" (use a dime). Loosen the set screw in the collars above and below the crossbar and adjust the agitator shaft as necessary. Then re-tighten the set screws in the collars.

## ORDERING SPARE PARTS

1. Identify the needed part by checking it against the photos, illustrations, and/or the parts list.
2. When ordering, please include part number, part name, and quantity needed.
3. Please include the machine's model name, serial number, and date of manufacture (located on the machine nameplate) with your order.
4. Address all parts orders to:

Parts Department  
Gold Medal Products Co.  
10700 Medallion Drive  
Cincinnati, Ohio 45241-4807

or, place orders at:  
(800) 543-0862  
(513) 769-7676  
Fax: (513) 769-8500  
E-mail: [info@gmpopcorn.com](mailto:info@gmpopcorn.com)  
Web Page: [www.gmpopcorn.com](http://www.gmpopcorn.com)

# Cabinet Breakdown

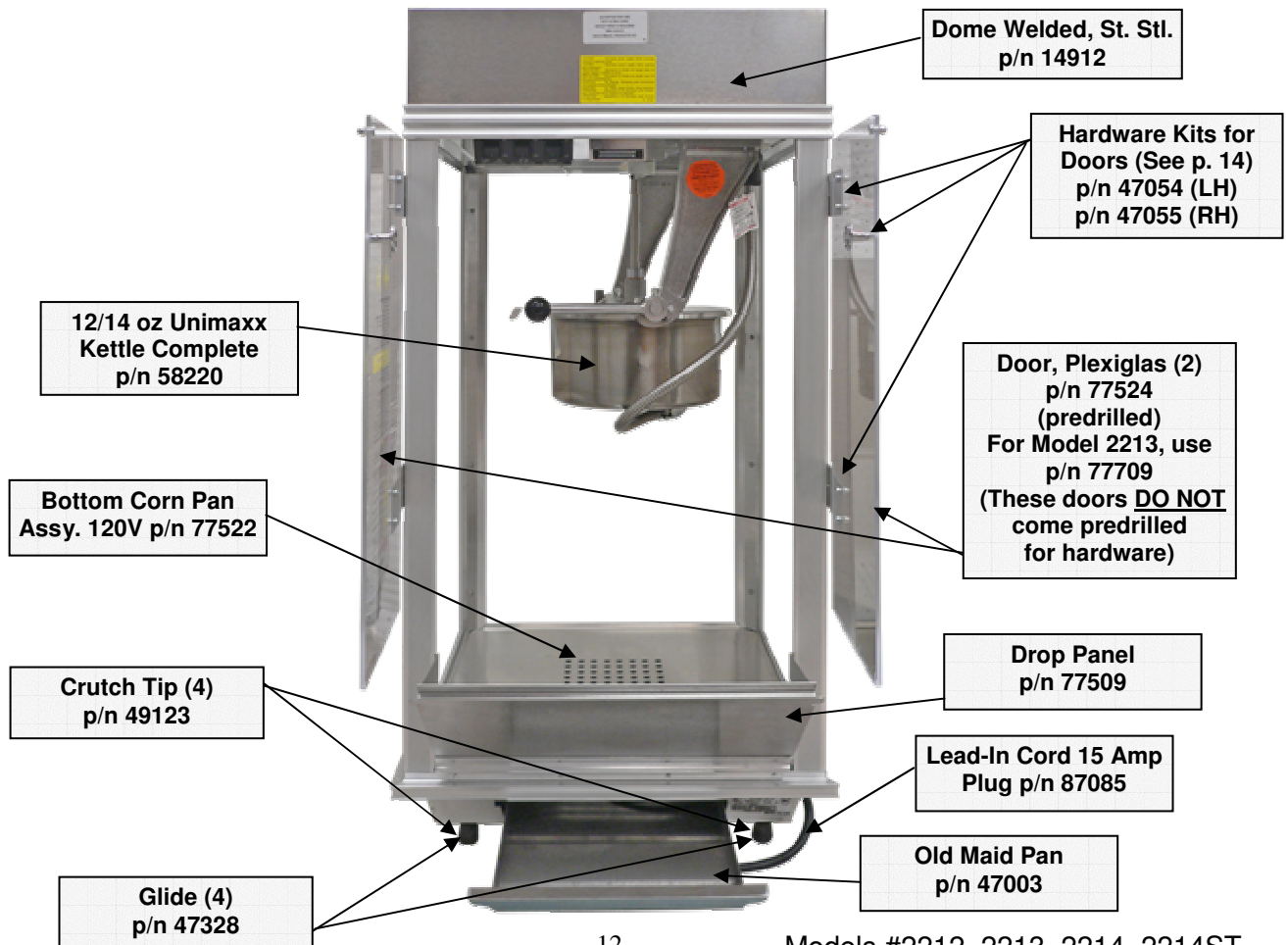
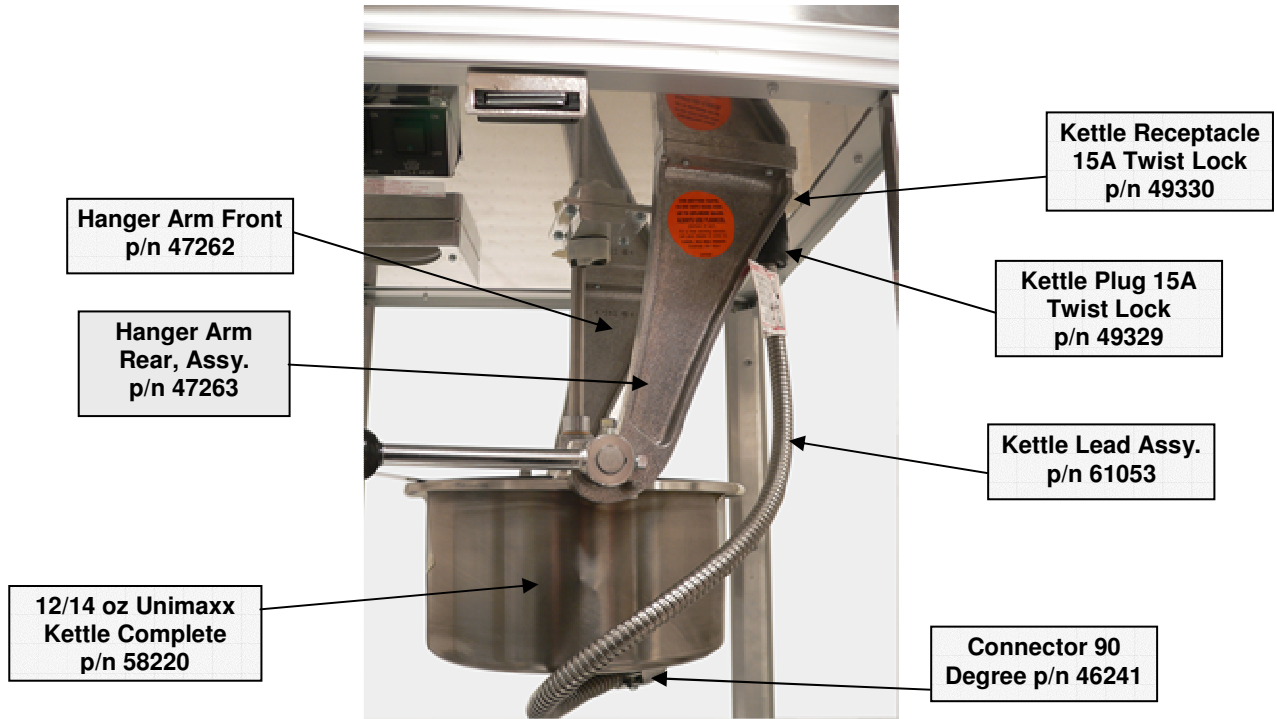

# Cabinet Breakdown (Con't)

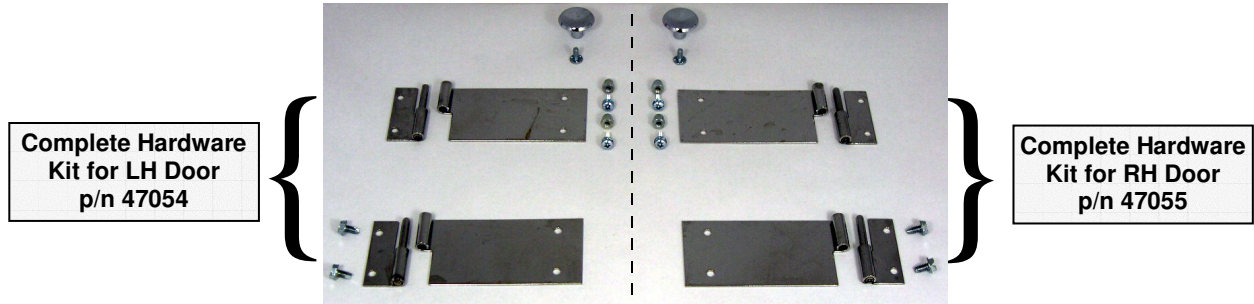

Complete Hardware Kit for LH Door p/n 47054

Complete Hardware Kit for RH Door p/n 47055

Door Hardware Kits

# Cabinet Interior – Ceiling Components

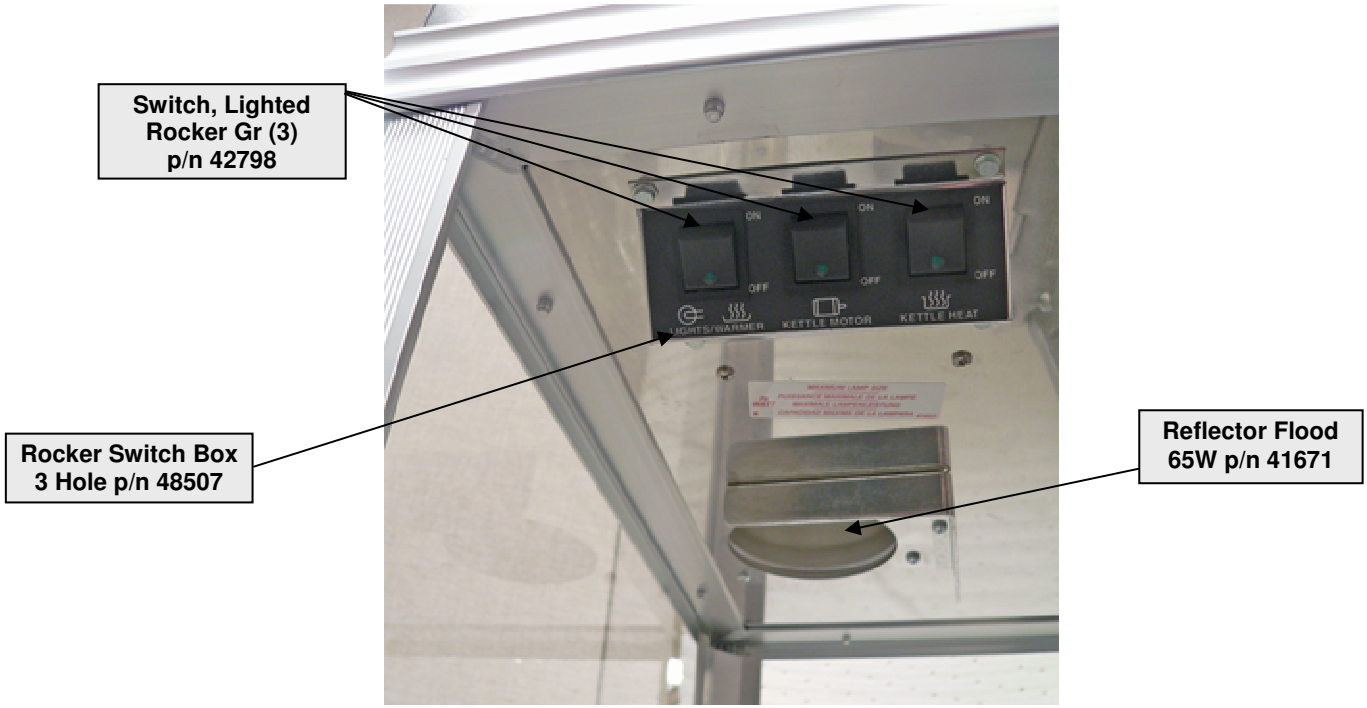

Switch, Lighted Rocker Gr (3) p/n 42798

Rocker Switch Box 3 Hole p/n 48507

Reflector Flood 65W p/n 41671

## Cabinet Interior – Ceiling Components (Con't)

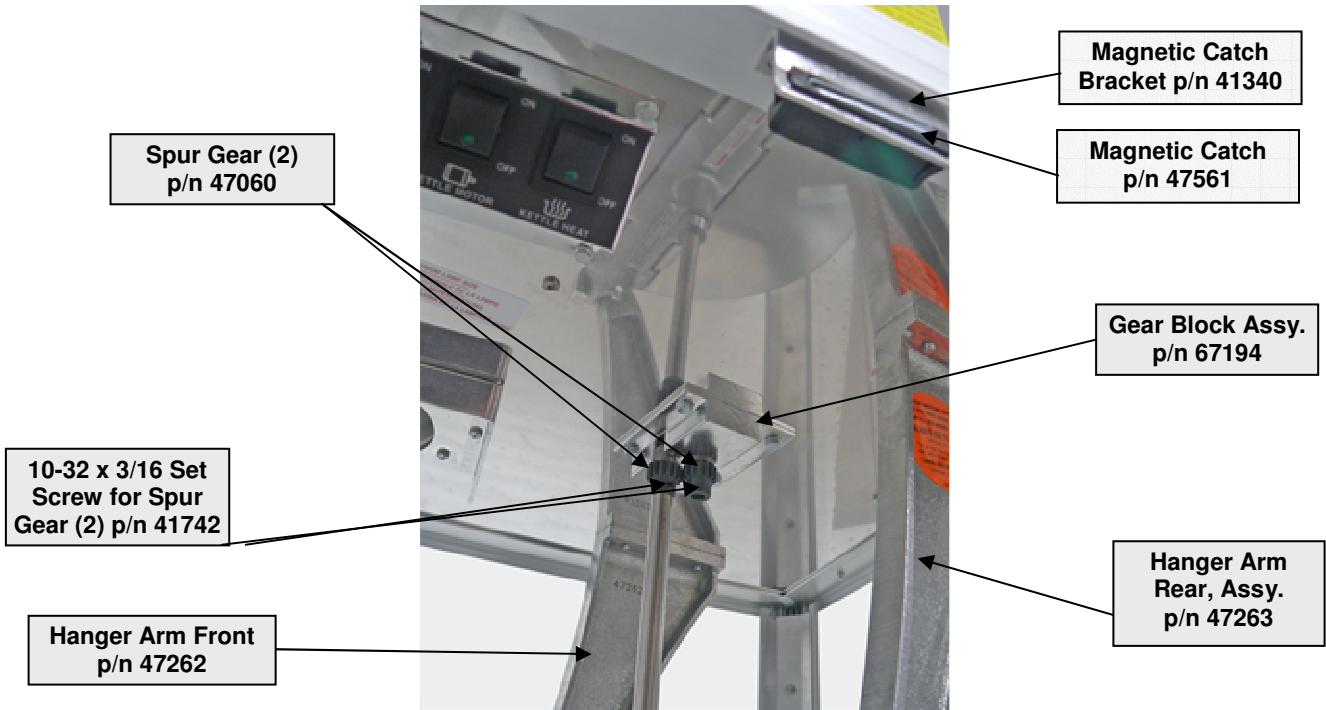

## Bottom Corn Pan Assembly – Part Number 77522

Complete Bottom Corn Pan Assembly Is Everything Shown Below, Including Female Cordset p/n 61020.

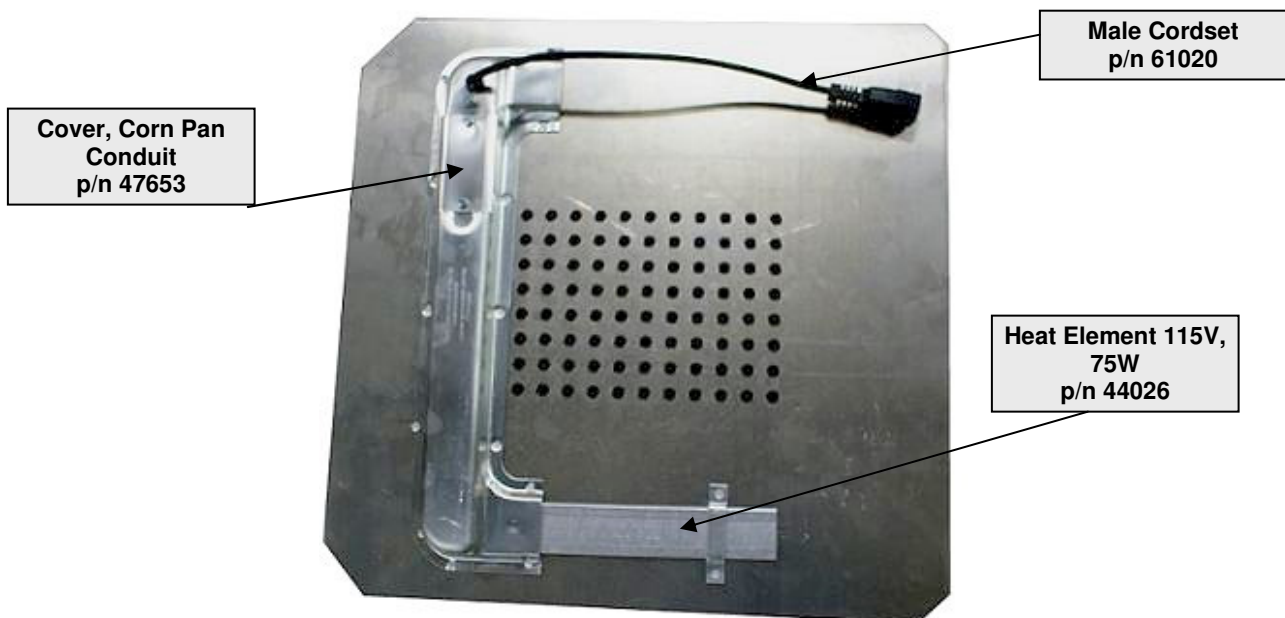



# Bottom Corn Pan Assembly – Part Number 77522 (Cont'd)

Female Cordset  
p/n 61020

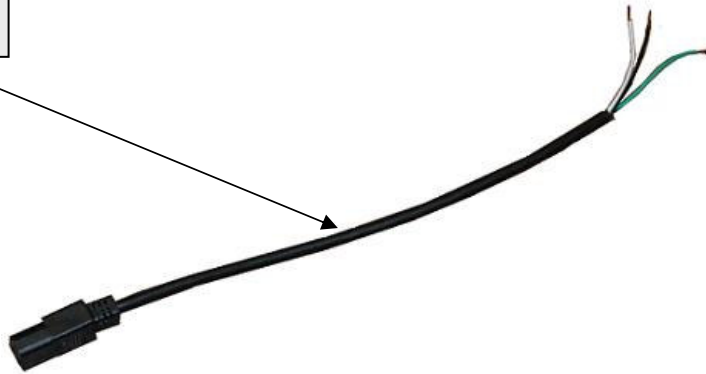

## Dome Assembly (2214ST only)

Dome Reflector  
Assembly, 120V  
p/n 41112

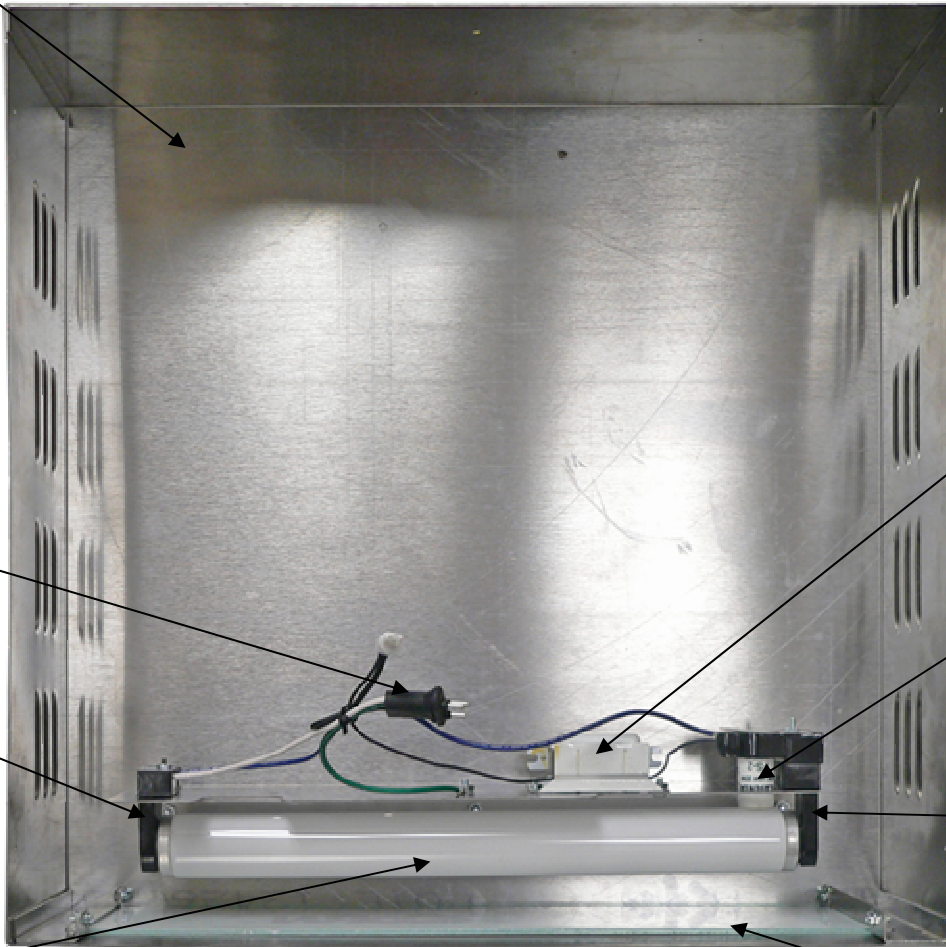

Molded Plug,  
Warmer p/n 47726

Light Ballast,  
120V 60 Hz  
p/n 41022

Light Starter  
p/n 41023

Light Tube Holder  
p/n 41020

Light Tube Holder  
Starter p/n 41021

Light Tube  
p/n 41057

Popcorn Sign  
p/n 49575



# Kettle Shell Components

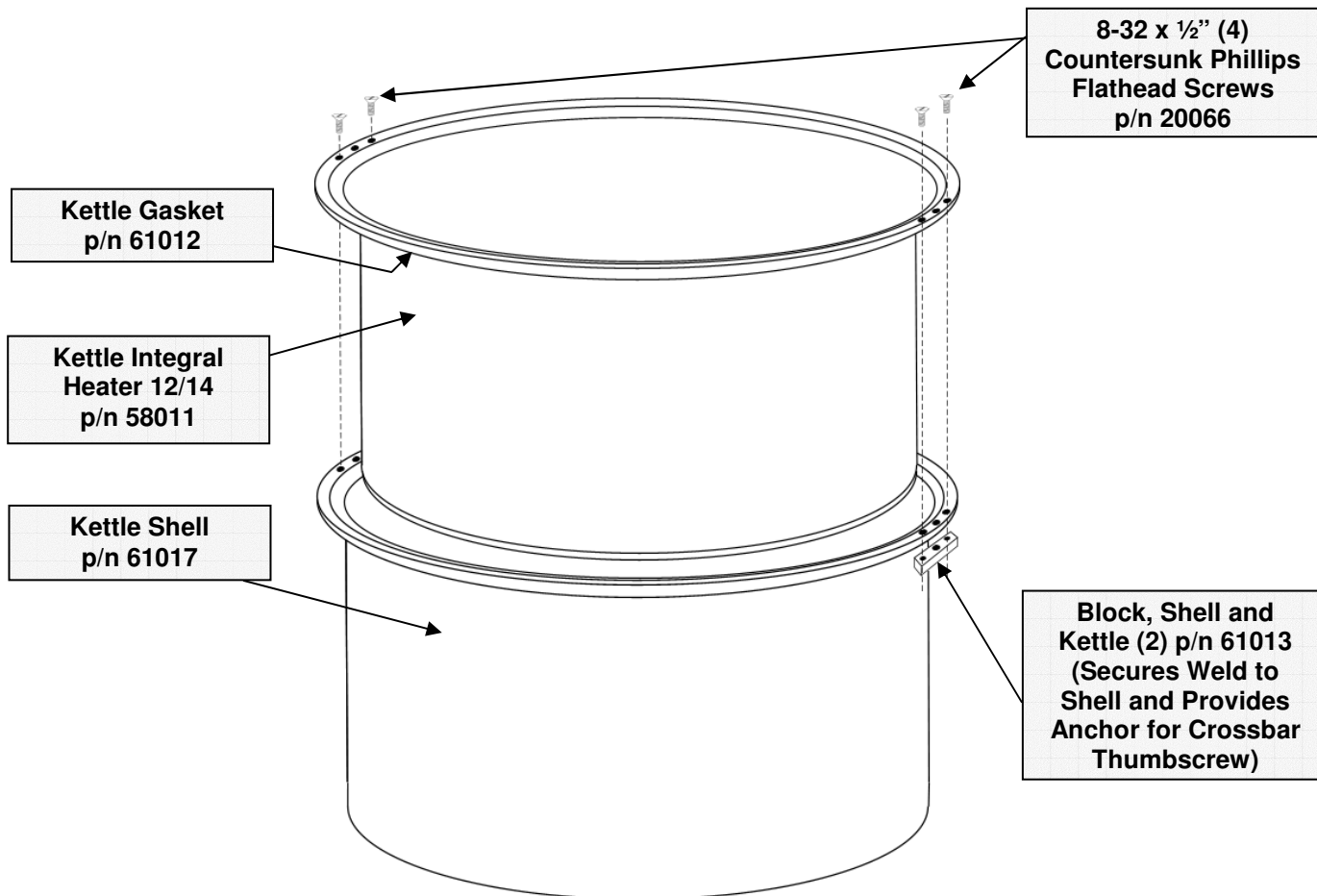

# Lid And Agitator Assy.

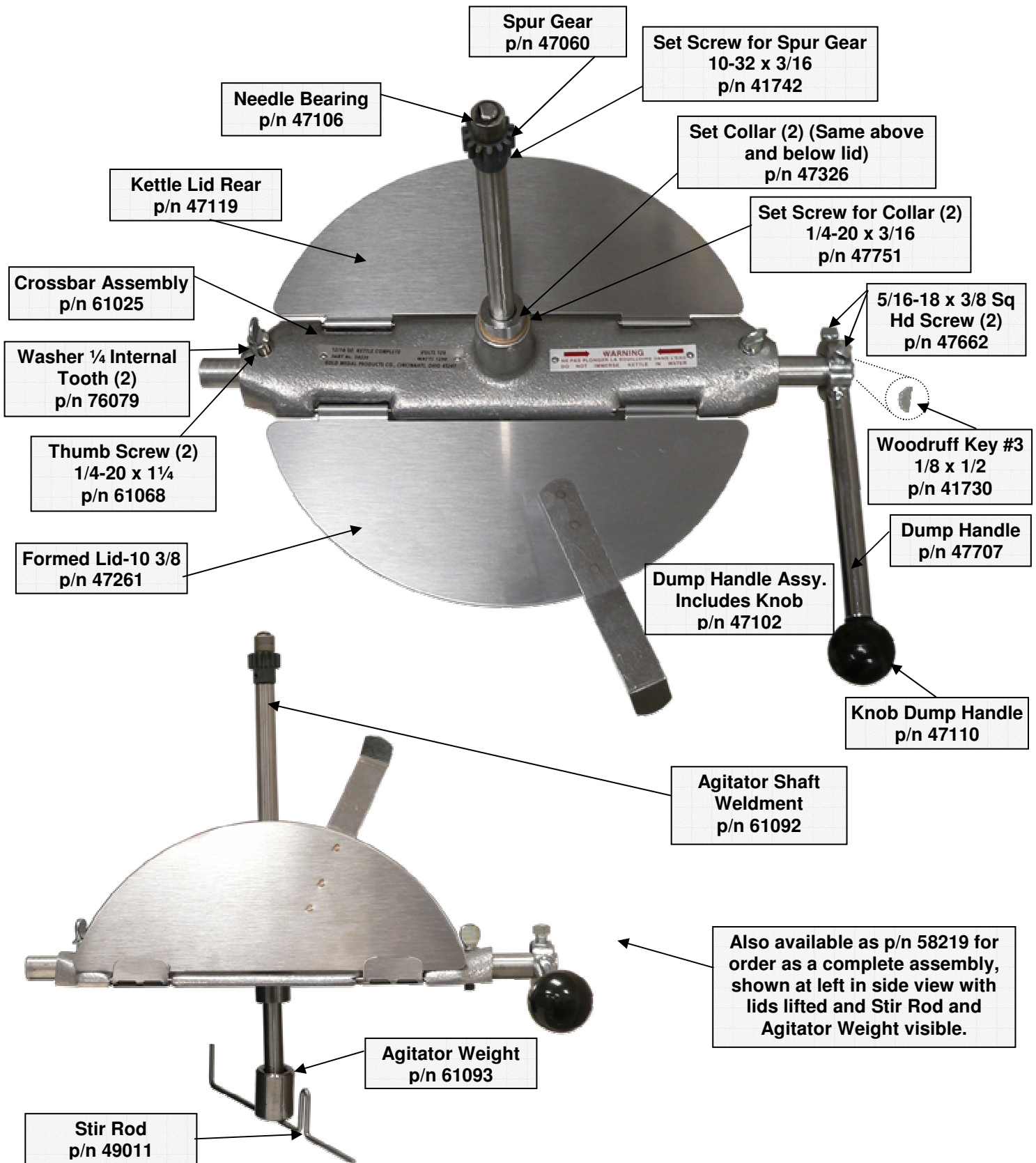

**Lid and Agitator Assembly**

# Unimaxx 12/14 OZ Kettle Specification

## UNIMAXX 12/14 OZ KETTLE

P/N 58220 - 120V

P/N 58220EX - 230V

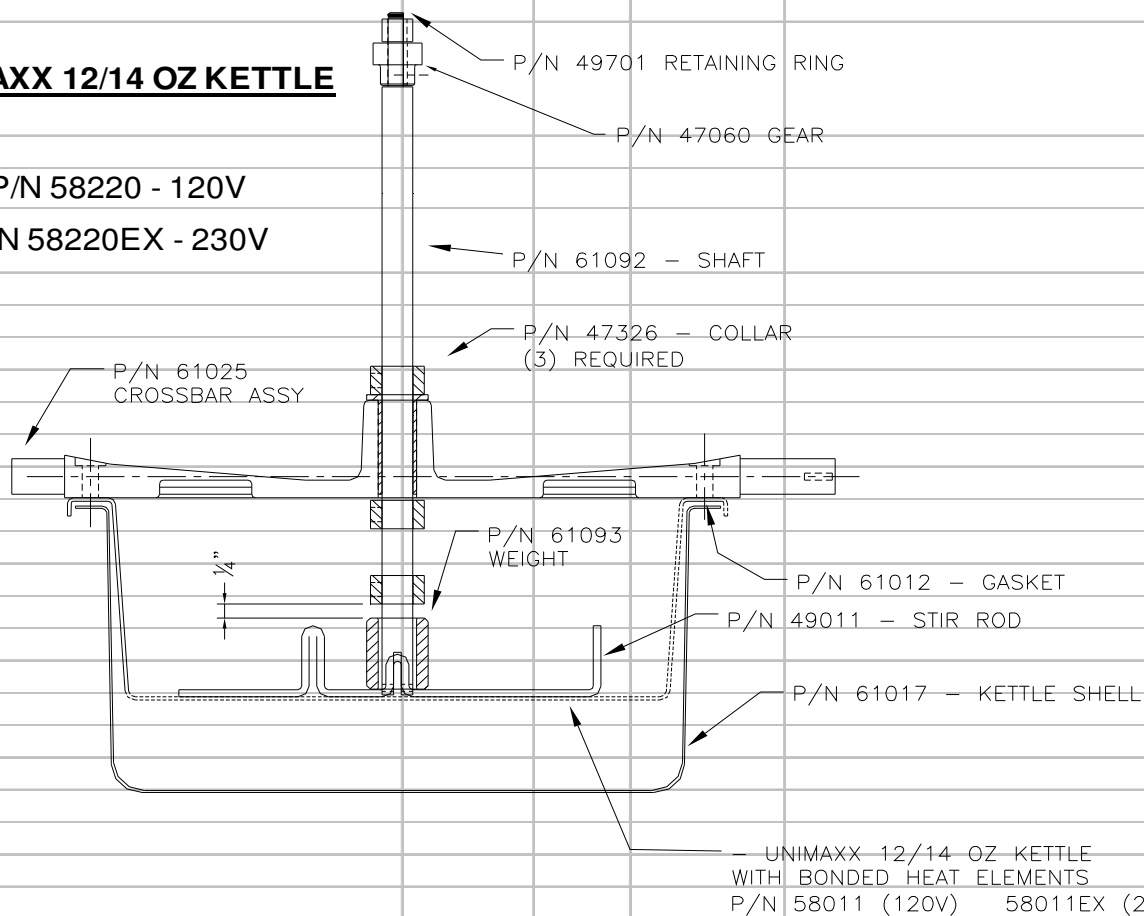

LID AND AGITATOR PARTS			KETTLE PARTS		
PART NUMBER	DESCRIPTION	QTY	PART NUMBER	DESCRIPTION	QTY
47707	DUMP HANDLE	1	58011	120V KETTLE W/ELEMENTS	1
47110	KNOB FOR DUMP HANDLE	1	58011EX	230V KETTLE W/ELEMENTS	1
47662	DUMP HANDLE SCREW	1	61017	KETTLE SHELL	1
41730	WOODRUFF KEY	1	61012	KETTLE GASKET	1
47119	REAR KETTLE LID	1	47193	THERMOSTAT SHUNT BAR	1
47261	FRONT KETTLE LID	1	76708	482F THERMOSTAT	1
47751	SET SCREW FOR 47326 COLLAR	3	77108	550F THERMOSTAT	1
47326	CLAMP COLLAR	3	89129	NUTS FOR THERMOSTATS	2
61025	CROSSBAR ASSEMBLY	1	61053	KETTLE LEAD ASSEMBLY	1
47097	BUSHING FOR CROSSBAR	1	82107-26	METAL FLEX CONDUIT	1
49011	STIR ROD	1			
61092	AGITATOR SHAFT	1			
47060	SPUR GEAR	1			
47106	NEEDLE BEARING	1			
49701	RETAINING RING FOR BRG	1			
61093	WEIGHT FOR STIR ROD	1			
61068	1/4" X 1 1/4" THUMB SCREW	2			
76079	WASHER FOR THUMB SCREW	2			

# Top - Motor Plate Assy.

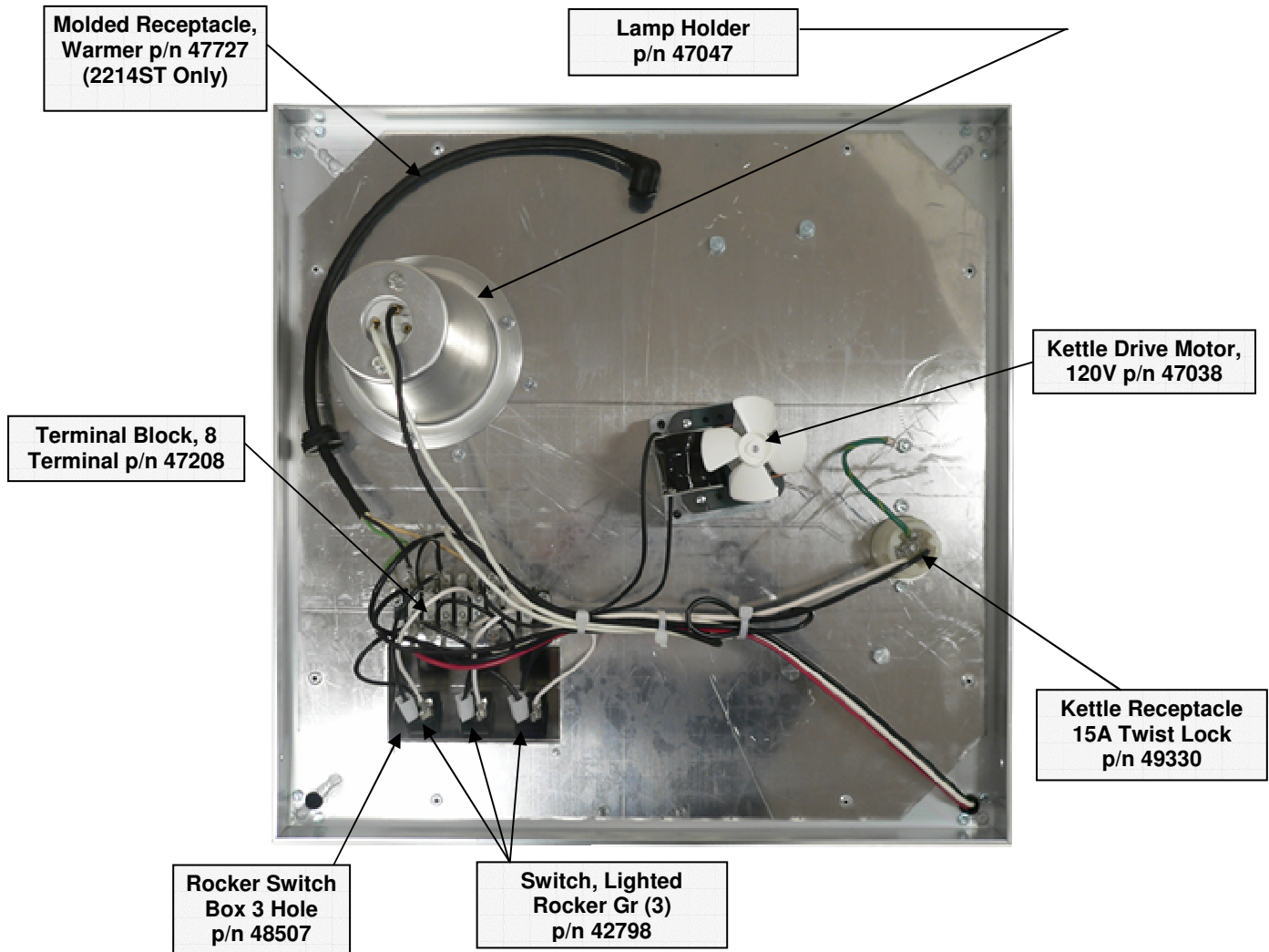

## Motor Plate Assembly

# Electrical Schematic

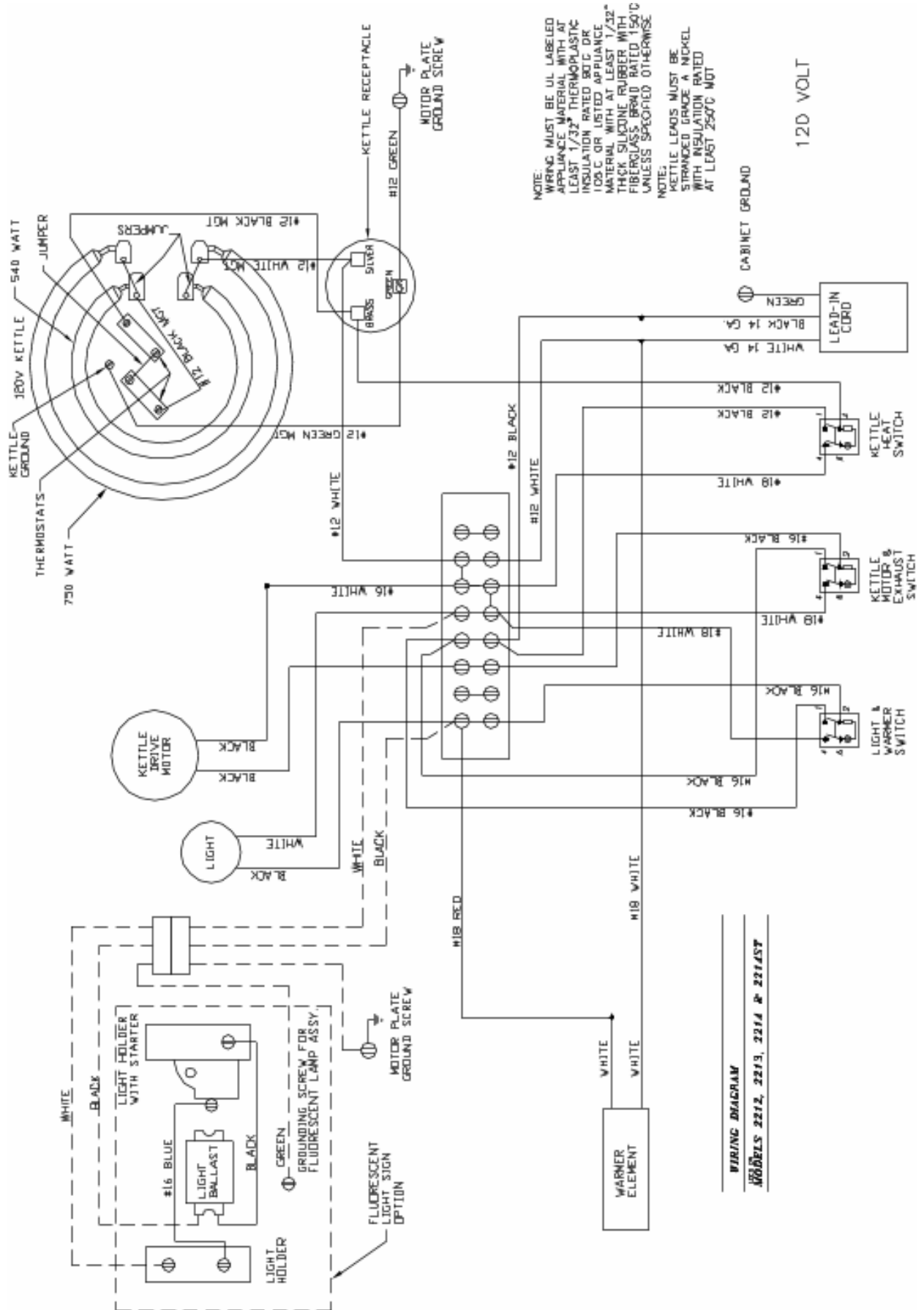

## WARRANTY

WE WARRANT to the original purchaser the Gold Medal equipment sold by us to be free from defects in material or workmanship under normal use and service. Our obligation under this warranty shall be limited to the repair or replacement of any defective part for a period of six (6) months from the date of sale to the Original Purchaser with regard to labor and two (2) years with regard to parts and does not cover damage to the equipment caused by accident, alteration, improper use, voltage, abuse, or failure to follow instructions.

THIS WARRANTY IS IN LIEU OF ALL OTHER WARRANTIES EXPRESSED OR IMPLIED, AND OF ALL OTHER OBLIGATIONS OR LIABILITIES ON OUR PART, INCLUDING THE IMPLIED WARRANTY OF MERCHANTABILITY. THERE ARE NO WARRANTIES WHICH EXTEND BEYOND THE DESCRIPTION ON THE FACE HEREOF. We neither assume, nor authorize any other person to assume for us, any other obligation or liability in connection with the sale of said GOLD MEDAL equipment or any part thereof.

The term "Original Purchaser" as used in this warranty shall be deemed to mean that person, firm, association, or corporation who was billed by the GOLD MEDAL PRODUCTS COMPANY, or their authorized distributor for the equipment.

THIS WARRANTY HAS NO EFFECT AND IS VOID UNLESS THE ORIGINAL PURCHASER FIRST CALLS GOLD MEDAL PRODUCTS COMPANY AT 1-800-543-0862 TO DISCUSS WITH OUR SERVICE REPRESENTATIVE THE EQUIPMENT PROBLEM, AND, IF NECESSARY, FOR INSTRUCTIONS CONCERNING THE REPAIR OR REPLACEMENT OF PARTS.

*NOTE: This equipment is manufactured and sold for commercial use only.*



**GOLD MEDAL PRODUCTS COMPANY**

**10700 Medallion Drive**

**Cincinnati, Ohio 45241-4807 USA**

**[www.gmpopcorn.com](http://www.gmpopcorn.com)**

**Phone: 1-800-543-0862**

**Fax: 1-800-542-1496**

© The text, descriptions, graphics and other material in this publication are the proprietary and exclusive property of Gold Medal Products Company and shall not be used, copied, reproduced, reprinted or published in any fashion, including website display, without its express written consent.