



Item # _____
Model # _____
Quantity _____
Project # _____

Specifications & Features

Model # PW5002-3

2-Door Warmer/Merchandiser

This versatile 2-Door Warmer/Merchandiser is ideal for front or rear counter applications. The operator side has the controls and a door for easy loading. The customer side door makes it a self-serve unit. The adjustable thermostat and circulating fan make this unit ideal for any application. The three adjustable chrome-plated racks can be placed flat or sloped and are removable for easy cleaning. Attractive Graphics help to create impulse sales. Stainless Steel and Aluminum construction provides durability and ease of cleaning



FEATURES:

- Designed for heating
- Adjustable thermostat, 450 watt element
- Temperature up to 160F
- Two doors for front or rear counter applications
- Tempered glass side and door panels
- Adjustable chrome-plated racks can be placed flat or sloped
- Clear glass door provides easy visibility
- Construction: Aluminum cabinet
- One year limited manufacturers warranty

Note: Dimensions and Specification are subject to change without notice.

Approvals

ETL

COZOC Group Inc.

18725 E Gale Ave, Ste 250
City of Industry, CA 91748

Phone: 253-678 8898
Fax: 626-956 0765
Email: info@cozoc.com
www.cozoc.com



Dimensions and Specifications

Model # PW5002-3
2-Door Warmer/Merchandiser

Item # _____

Model # _____

Quantity _____

Project # _____

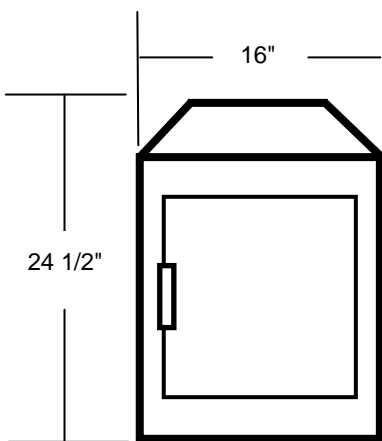

Front View

Model:PW5002-3

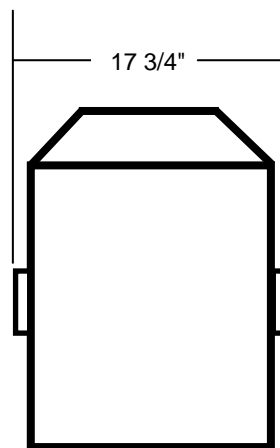

Side View

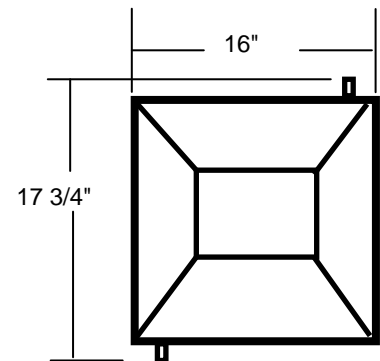

Top View

Approvals: ETL

Electrical: 120 Volt, 60 HZ (450 Watts)
(or) 220 Volt, 50 HZ

Options: -LED Thermometer

Dimensions: 16"x 17 3/4" D x 24 1/2" H

Net Weight: 36 pounds

Gross (Shipping) Weight: 40 pounds

Package: 17 3/4" W x 19 3/4" D x 25"H

Note: Dimensions and specifications are subject to change without notice.

COZOC Group Inc.

18725 E Gale Ave, Ste 250
City of Industry, CA 91748

Phone: 253-678 8898

Fax: 626-956 0765

Email: info@cozoc.com

www.cozoc.com